



Features

- Available in 28 finishes including 13 PVD finishes
- All brass construction
- 1/4 turn ceramic disc cartridge(s)
- Dual jointed swing spout
- 1/2" FIP inlet for quick connect
- Max flow rate: 4.0 gpm (15.1 L/min) at 60 psi

Codes/Standards Applicable

Product meets or exceeds the following:

- ASME A112.18.1/CSA B125.1
- NSF 61, NSF 372
- Commonwealth of MA
- ADA compliant (Lever handles only)



K10-201-47 SHOWN



XX = Series handle

SERIES	A	B
33	1-1/2" [38]	3-1/8" [79]
34	1-1/2" [38]	1-1/8" [29]
35	1-1/4" [32]	3-1/2" [89]
36	1-1/4" [32]	3-1/8" [79]
38	1-13/16" [46]	2-7/8" [73]
42	1-1/2" [38]	3-1/8" [79]
46	1-1/2" [38]	3-7/8" [98]
47	1-3/8" [35]	1-3/8" [35]
48	1-1/16" [27]	3-1/8" [79]
48X	1-1/16" [27]	1-1/2" [38]
55	1-1/2" [38]	3-5/16" [84]
59	1-13/16" [46]	3" [76]
60	1-3/16" [30]	1-5/16" [33]
63	1-7/16" [37]	1-3/8" [35]
64	1-1/2" [38]	3-5/16" [84]
67	1-1/2" [38]	1-3/8" [35]
68	1-1/4" [32]	3-5/16" [84]
69	1-1/4" [32]	3-1/2" [89]
CLEV	1-1/4" [32]	3-1/2" [89]
CBALL	2-1/2" [64]	3/4" [19]

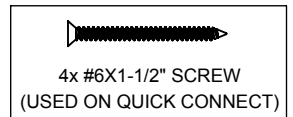
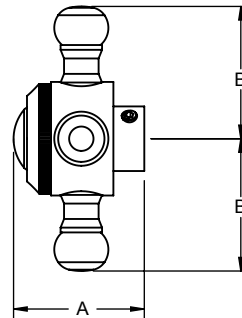
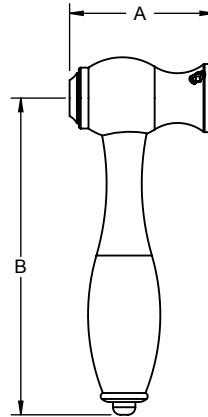

Thru-Hole Specifications		
Min	Recommended	Max
∅ 1-1/8" [29]	∅ 1-1/8" [29]	∅ 1-1/4" [32]